



March 5, 2021

Mr. Alan Montanelli  
City of Stockton Municipal Utilities Department  
2500 Navy Dr.  
Stockton CA 95206

Dear Alan:

**Subject: North Newcastle Road  
Storm Drainage Basin Maintenance District**

On behalf of Siegfried Engineering, Inc., Engineer of Work for the subject maintenance district, I am submitting the following documents for the subject Maintenance District:

1. Proposed 2020-2021 Fiscal Year Budget.
2. Schedule of parcels and assessment amounts for the 2020-2021 budget and a list of the description of parcels by Assessor Parcel Number (A.P.N.).
3. Original Assessment Diagram for North Newcastle Road Storm Drainage Basin Maintenance District.

The submittal appropriately addresses the requirements of Proposition 218 in that the parcels within the subject district receive one hundred percent (100%) of special benefits from the subject district and zero percent (0%) of general benefits.

Sincerely,  
**SIEGFRIED**

A handwritten signature in blue ink, appearing to read "Paul J. Schneider", is written over a horizontal line.

Paul J. Schneider, P.E.

PJS/jh

Enclosure

cc: Mr. Kevin Beltz, City of Stockton, Finance Department (w/ encl.)  
City of Stockton, City Clerk's Office (w/ encl.)



**Stockton**  
3428 Brookside Rd.  
Stockton, CA 95219  
t: 209.943.2021

**San Jose**  
111 N. Market St., #300  
San Jose, CA 95113  
t: 408.754.2021

**Sacramento**  
900 Howe Ave, #200  
Sacramento, CA 95825  
t: 916.520.2777

**Modesto**  
100 Sycamore Ave, #100  
Modesto, CA 95354  
t: 209.762.3580

**NORTH NEWCASTLE  
STORM DRAINAGE BASIN MAINTENANCE DISTRICT  
PROPOSED 2021-2022 FISCAL YEAR BUDGET**

---

<b>Maintenance and Repair Services</b>	<b>\$46,181.00</b>
City of Stockton Publicity and Advertising Costs	\$68.00
Maintenance District Attorney Fee	\$750.00
San Joaquin County Processing Fees	\$120.00
District Engineering Annual Engineer's Report	\$3,060.00
Professional Services	\$3,000.00
City of Stockton Administrative Costs	\$5,000.00
<b>Total Administrative Costs</b>	<b>\$58,179.00</b>
Contingency	\$4,617.88
<b>Total 2021-2022 Budget</b>	<b>\$62,796.88</b>

**Amount to be assessed by  
North Newcastle** **\$62,796.88**

The improvements being maintained by this district are a storm water retention basin and appurtenances which are site specific to the parcels being assessed. The improvements and appurtenances do not provide any benefit to any parcel or parcels outside the boundaries of the district. In the opinion of the undersigned, the benefits received by the parcels assessed within the Arch Road Industrial Park, Storm Drain Maintenance District, from the Arch Road Industrial Park, Storm Basin Maintenance District, are identified as set forth by Proposition 218 as follows:

**Special Benefits - 100%**  
**General Benefits - 0%**

Siegfried Engineering, Inc.  
Engineer of Work,

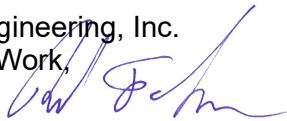

2021-03-05

---

Paul J. Schneider, P.E.

---

Date

North Newcastle  
Storm Drainage Basin Maintenance District

**SCHEDULE OF PARCELS, ADJUSTED DRAINAGE AREAS and  
ASSESSMENT AMOUNTS FOR 2021-2022 BUDGET**

March 5, 2021

Maintenance District Assessment Number	Assessor's Parcel Number	Adjusted Area (acres)	Assessment Benefit Factor	2021-2022 Assessment Amount
1	179-200-27	20.76	0.05614	\$3,525.54
2	179-220-11	7.46	0.02017	\$1,266.88
3	179-220-33	0.29	0.00078	\$49.24
4	179-220-34	42.41	0.11469	\$7,202.24
5	179-220-35	61.84	0.16724	\$10,501.92
6	179-220-39	54.65	0.14779	\$9,280.88
7	179-220-40 <sup>3</sup>	0.74	0.00199	\$125.04
8	179-220-41	67.72	0.18314	\$11,500.48
9	179-220-42 <sup>2</sup>	0.00	0.00000	\$0.00
10	179-220-43 <sup>2</sup>	0.00	0.00000	\$0.00
11	179-220-44 <sup>2</sup>	0.00	0.00000	\$0.00
12	179-220-45 <sup>2</sup>	0.00	0.00000	\$0.00
13	179-220-46	6.03	0.01631	\$1,024.04
14	181-100-14	39.42	0.10660	\$6,694.46
15	181-100-16	52.76	0.14268	\$8,959.92
16	181-100-17	15.70	0.04246	\$2,666.24
	<b>TOTALS</b>	<b>369.78</b>	<b>1.00</b>	<b>\$62,796.88</b>

Note:

1. See Exhibit B for Budget and CIP Analysis
2. Denotes a parcel that is either owned by the City or part of Little John's Creek
3. APN 179-220-40 will have 8,435sf dedicated to the City for the pump station
4. Parcels 179-220-33, 39, and 40 total 55.87ac less the 8,435sf dedication

**EXHIBIT C**  
**ASSESSMENT DISTRICT BOUNDARY MAP**  
**& ASSESSMENT DIAGRAM**

**CITY OF STOCKTON NORTH NEWCASTLE STORM PUMP  
STATION AND BASIN ASSESSMENT DISTRICT NO. 20-1**

STOCKTON, SAN JOAQUIN COUNTY  
STATE OF CALIFORNIA

June, 2020



**SIEGFRIED**  
3428 Brookside Road Stockton, California 95219  
209-943-2021 www.siegfriedeng.com Fx: 209-942-0214

- CIVIL
- STRUCTURAL
- LANDSCAPE ARCHITECTURE
- SURVEYING
- PLANNING
- ATHLETIC FACILITY DESIGN

FILED IN THE OFFICE OF THE CITY CLERK OF THE CITY OF STOCKTON  
THIS \_\_\_\_\_ DAY OF \_\_\_\_\_, 20\_\_

\_\_\_\_\_  
CITY CLERK OF THE CITY OF STOCKTON

RECORDED IN THE OFFICE OF THE SUPERINTENDENT OF STREETS  
THIS \_\_\_\_\_ DAY OF \_\_\_\_\_, 20\_\_

\_\_\_\_\_  
SUPERINTENDENT OF STREETS OF THE CITY OF STOCKTON

AN ASSESSMENT WAS LEVIED BY THE CITY COUNCIL OF THE CITY OF STOCKTON COUNTY OF SAN JOAQUIN, STATE OF CALIFORNIA, ON THE LOTS, PIECES AND PARCELS OF LAND SHOWN ON THE AMENDED ASSESSMENT DIAGRAM. SAID ASSESSMENT WAS LEVIED ON \_\_\_\_\_. SAID AMENDED ASSESSMENT DIAGRAM AND THE ASSESSMENT ROLL WERE RECORDED IN THE OFFICE OF THE SUPERINTENDENT OF STREETS OF SAID CITY ON \_\_\_\_\_. REFERENCE IS MADE TO THE ASSESSMENT ROLL RECORDED IN THE OFFICE OF THE SUPERINTENDENT OF STREETS FOR THE EXACT AMOUNT OF EACH ASSESSMENT LEVIED AGAINST EACH PARCEL OF LAND SHOWN ON THIS AMENDED ASSESSMENT DIAGRAM.

\_\_\_\_\_  
CITY CLERK OF THE CITY OF STOCKTON

FILED THIS \_\_\_\_\_ DAY OF \_\_\_\_\_, 20\_\_, AT THE HOUR OF \_\_\_\_\_ O'CLOCK \_\_\_\_ M, IN THE BOOK \_\_\_\_\_ OF MAPS OF ASSESSMENT DISTRICTS AT PAGE \_\_\_\_\_, IN THE OFFICE OF THE COUNTY RECORDER OF THE COUNTY OF SAN JOAQUIN, STATE OF CALIFORNIA.

\_\_\_\_\_  
COUNTY RECORDER OF THE COUNTY OF SAN JOAQUIN, STATE OF CALIFORNIA

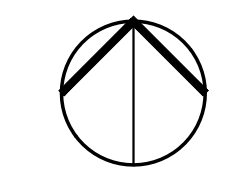
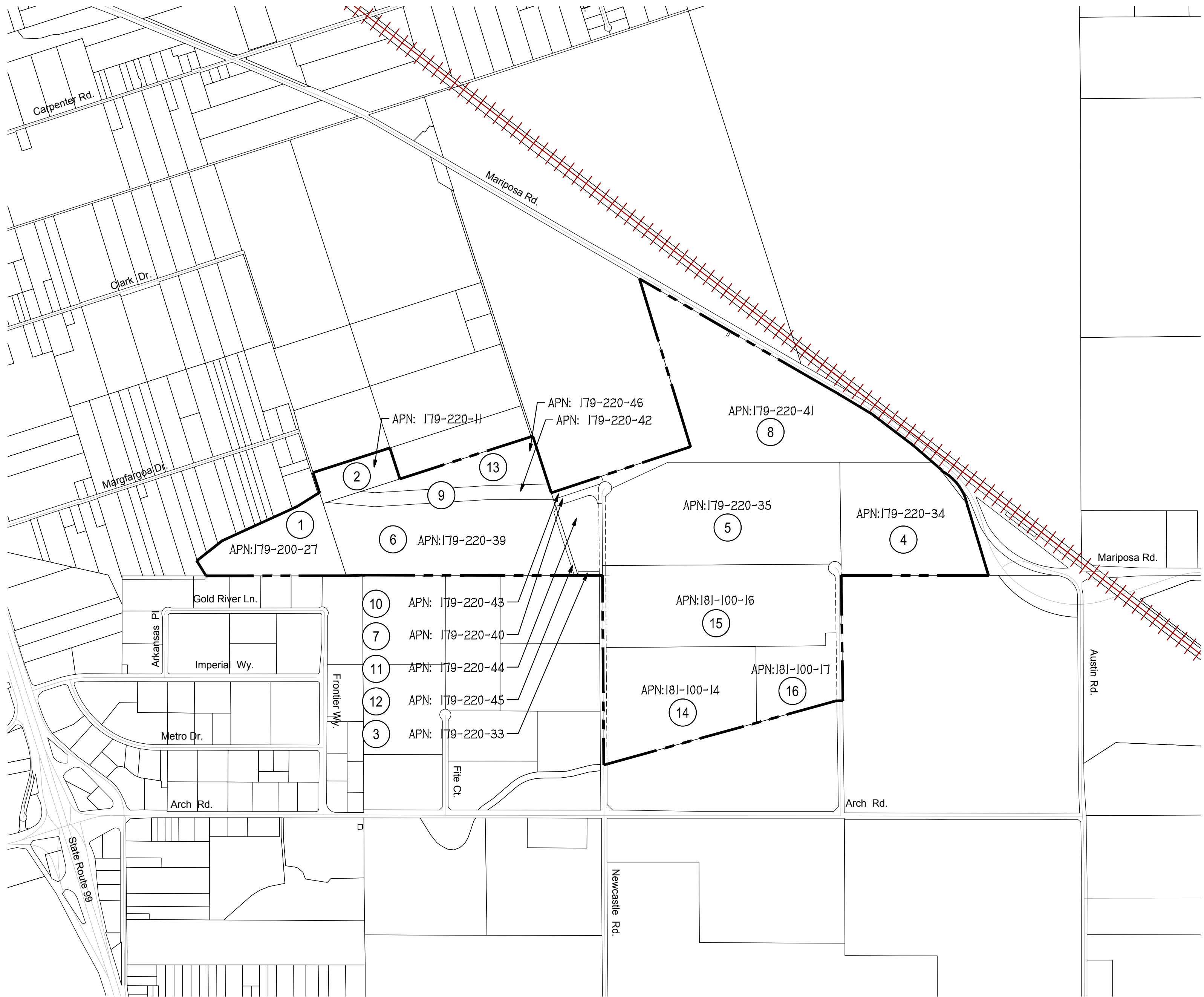

- LEGEND:**
- ASSESSMENT DISTRICT BOUNDARY
  - PARCEL LINES
  - APN: 179-220-32 APN NUMBER
  - ① MAINTENANCE DISTRICT ASSESSMENT NUMBER

**NOTES:**  
PARCEL MAP 26-119 19-20